



Stirling 23

 4  2.5  2

Size: 23sqs / 210sqm

Contemporary, double storey living

Efficiently designed to suit the block, this generous home is large enough for a growing family ticking all the boxes with inclusions. Includes 4 bedrooms, 2.5 bathrooms, generous storage space and a double car garage.

All site costs are included for a standard building block.

CHOOSE FROM OUR 'VALUE PLUS' OR 'LIFESTYLE' INCLUSIONS RANGE

Our prices include all site costs

- ✓ Council requirements & preliminaries
- ✓ Site works
- ✓ Connection services
- ✓ Energy efficiency & BASIX

KEY FEATURES:

- › Double storey
- › Open plan family, dining and kitchen
- › Master with ensuite and walk in robe
- › Designer kitchen with stone benchtops
- › Walk in pantry
- › Covered alfresco incl. concrete slab

Phone: 1300 30 11 38
worthingtonhomes.com.au

Licence number: 222440C

**WORTHINGTON
HOMES**

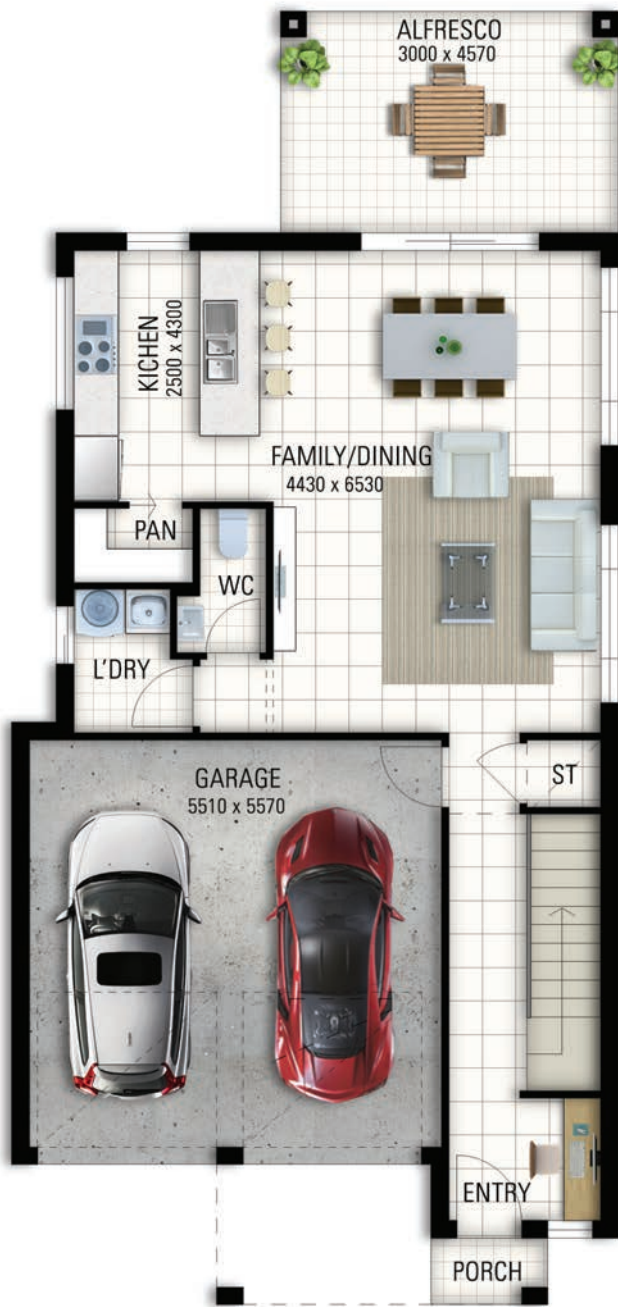

Ground floor



First floor